

Hyatt Regency Denver

At Colorado Convention Center

ROOM DIMENSIONS & CAPACITIES

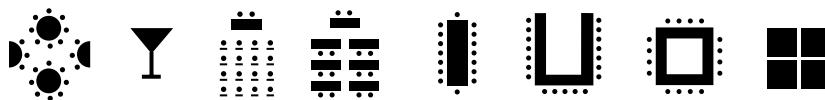

Room Name

Room Name	Room Dimensions Length x Width x Height	Square Feet	Banquet	Reception	Theater	Classroom	Boardroom	U-Shape	Hollow Square	Exhibit
THIRD LEVEL										
CENTENNIAL BALLROOM	117' x 250' x 30'	30,000	1,890	3,000	2,200	1,900	—	—	—	180
A	39' x 55' x 30'	2,145	90	220	160	130	46	48	60	13
B	36' x 55' x 30'	1,980	90	200	140	110	40	42	60	10
C	39' x 55' x 30'	2,145	90	220	160	130	46	42	60	13
CORRIDOR D	117' x 17' x 30'	1,989	—	—	—	—	—	—	—	—
D	117' x 49' x 30'	5,733	360	600	430	370	—	—	—	36
E	117' x 44' x 30'	5,148	270	500	380	310	—	—	—	26
CORRIDOR E	117' x 19' x 30'	2,223	—	—	—	—	—	—	—	—
F	39' x 59' x 30'	2,301	90	220	160	130	46	48	60	14
G	36' x 59' x 30'	2,124	90	200	140	120	46	48	60	12
H	39' x 59' x 30'	2,301	90	220	160	130	46	48	60	14
CENTENNIAL FOYER	—	10,600	400	1,200	—	—	—	—	—	26
MINERAL HALL	151' x 54' x 10'	8,154	470	540	620	480	—	—	—	42
A	26' x 54' x 30'	1,404	80	140	90	80	44	39	48	—
B	37' x 26' x 10'	962	50	100	70	45	28	30	36	—
C	37' x 28' x 10'	1,036	50	100	80	45	28	30	36	—
CORRIDOR	10' x 54' x 10'	540	—	—	—	—	—	—	—	—
D	37' x 26' x 10'	962	50	100	70	45	28	30	36	—
E	37' x 28' x 10'	1,036	50	100	70	45	28	30	36	—
F	37' x 26' x 10'	962	50	100	80	45	28	30	36	—
G	37' x 28' x 10'	1,036	50	100	80	45	28	30	36	—
MINERAL HALL FOYER	—	2,400	70	120	—	—	—	—	—	—
AGATE	60' x 32' x 10'	1,800	60	140	110	66	46	42	48	8
A	18' x 31' x 10'	558	20	50	30	20	16	15	18	—
B	19' x 30' x 10'	570	20	50	30	18	16	15	18	—
C	23' x 29' x 10'	667	20	70	40	24	20	15	18	—
GRANITE	61' x 27' x 10'	1,647	70	140	110	66	52	48	54	8
A	21' x 27' x 10'	567	20	60	40	24	20	18	24	—
B	20' x 27' x 10'	540	20	50	30	21	18	12	18	—
C	19' x 26' x 10'	494	20	50	30	21	18	12	24	—
QUARTZ	44' x 25' x 10'	1,100	50	100	70	54	34	36	42	6
A	23' x 25' x 10'	575	20	60	30	24	18	18	18	—
B	21' x 25' x 10'	525	20	40	30	24	18	18	18	—
SLATE	—	288	STORAGE OR OFFICE SPACE							
FOURTH LEVEL										
CAPITOL BALLROOM	141' x 94' x 22'	14,000	840	1,200	960	750	—	—	—	80
1	41' x 32' x 22'	1,312	60	140	90	72	34	33	42	—
2	41' x 29' x 22'	1,189	60	130	80	54	34	33	42	—
3	41' x 31' x 22'	1,271	60	140	90	72	34	33	42	—
CORRIDOR NORTH	11' x 94' x 22'	1,034	—	—	—	—	—	—	—	—
4	33' x 94' x 22'	3,102	140	300	210	180	—	—	90	14
CORRIDOR SOUTH	12' x 94' x 22'	1,128	—	—	—	—	—	—	—	—
5	42' x 31' x 22'	1,302	60	140	90	72	34	33	42	—
6	42' x 29' x 22'	1,218	60	130	80	54	34	33	42	—
7	42' x 32' x 22'	1,344	60	140	90	72	34	33	42	—
CAPITOL FOYER	—	8,000	320	900	—	—	—	—	—	18
LIMESTONE	—	560	PERMANENT BOARDROOM SEATING FOR 14							
SANDSTONE	—	525	PERMANENT BOARDROOM SEATING FOR 14							
MARBLE	—	540	PERMANENT BOARDROOM SEATING FOR 14							
FLAGSTONE A	—	99	STORAGE OR OFFICE SPACE							
FLAGSTONE B	—	99	STORAGE OR OFFICE SPACE							
SUMMIT 25 & 26	25' x 24' x 7'	380	12	—	24	12	12	9	12	—



Hyatt Regency Denver

At Colorado Convention Center

LOCATION

- Situated in the Central Business District in Denver
- Directly across from the Colorado Convention Center
- Surrounded by California St., 14th St., Welton St. and 15th St.

THIRD LEVEL

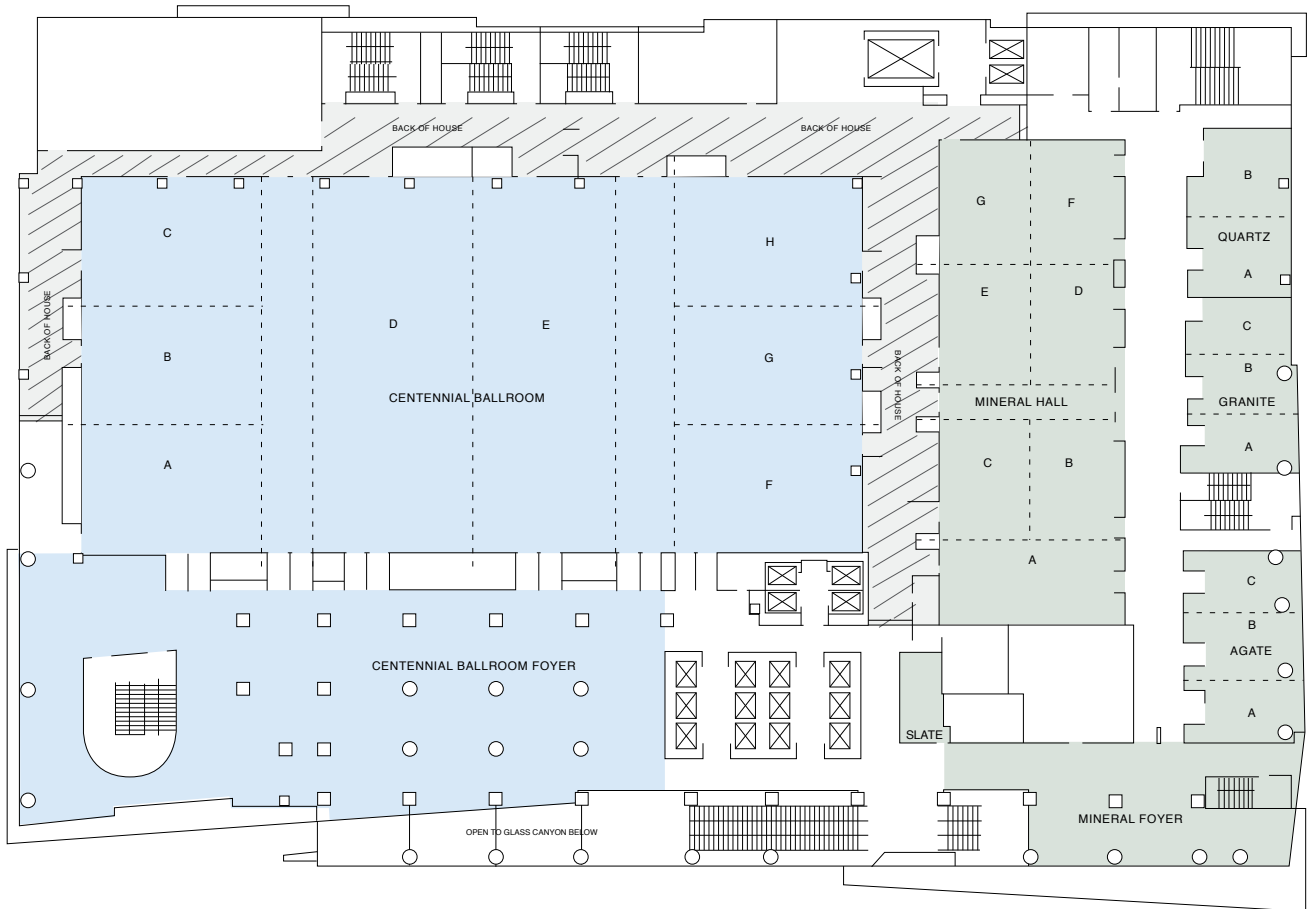

Hyatt Regency Denver
At Colorado Convention Center

FOURTH LEVEL

